

# FEP

## LONG BONE EXTERNAL FIXATOR

Modular  
Versatile  
Lightweight



# Indications

Closed, open and pathological fractures of long bones.  
Non-unions, correction of limb deformities (axial corrections and hypometria).

## FEATURES

Made of Aluminium alloy 7012  
Available in three sizes (small, medium and large)

## ADVANTAGES

Lightweight  
Wide range of applications

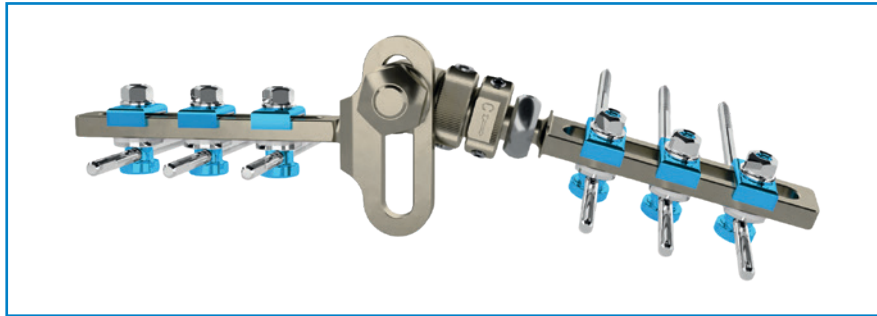

FEP allows independent corrections to be made on all three planes thanks to its features and the modularity of its accessories. The central joint unit allows for procurved and recurved correction. The compression-distraction unit corrects rotational defects and axial movement along the diaphysis. The handles and micrometric adjusters, acting on the gripping elements, allow for varus and valgus correction. Each correction can be made independently on each plane without losing the previous correction.

## Clamp modularity

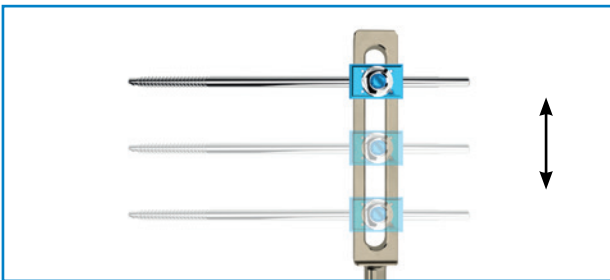

Longitudinal sliding on rail bars

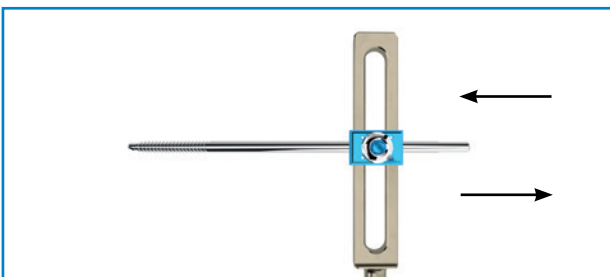

Lateral sliding of the gripping elements on the rail bar

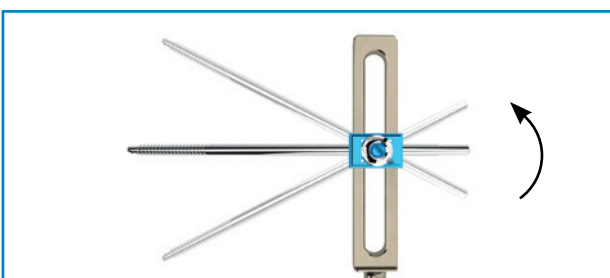

Rotation of the clamp on the rail, with the possibility of tilting the gripping elements

# Fixator models

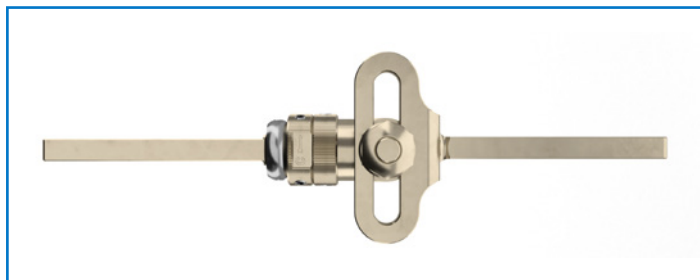

Large fixator

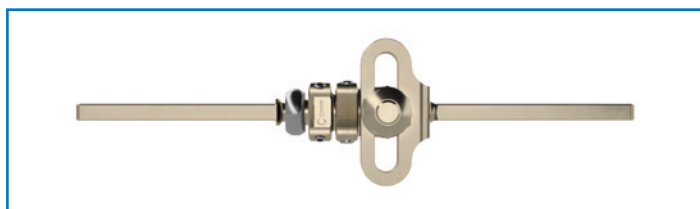

Medium fixator

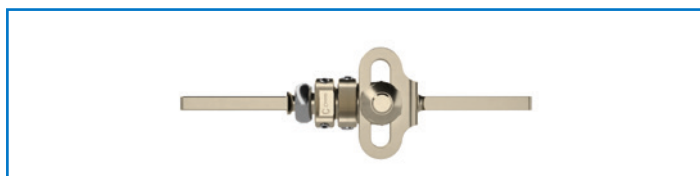

Small fixator

Code	Description
5000060	Small dynamisable base element
5000067	Medium dynamisable base element
5000068	Large dynamisable base element

The body of the fixator comes without clamps and is shipped NON-sterile.

## Angular fixator

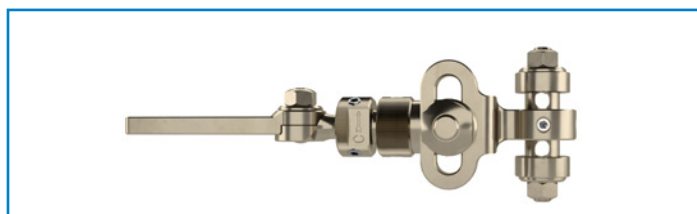

This fixator may be used in metaepiphyseal fractures and angular corrections of the lower limbs. The fixator is equipped with a pair of clamps in a 'T' layout and, at the other end, a rail bar connected to the body by a hinge.

Code	Description
5000061	Large angular element
5000062	Medium angular element

The body of the fixator comes without diaphyseal clamps and is shipped NON-sterile.

# Clamps

Disposable, available in single and sterile packs.

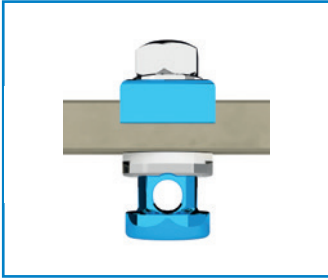

Single clamp.

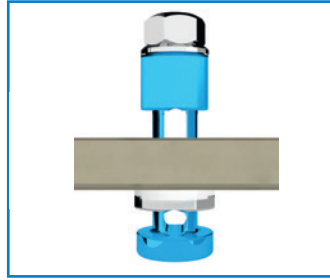

Extended or 'T' clamp.  
Allows a pair of parallel screws to be used.

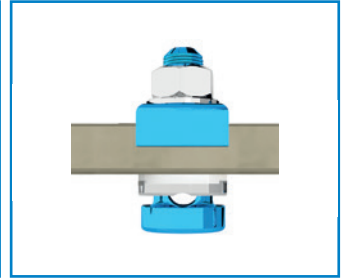
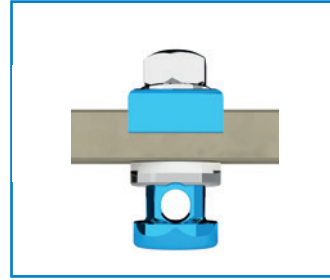

Large model clamps can accommodate screws and/or wires having a diameter between 1.5 mm and 6.0 mm. Small and medium model clamps can accommodate screws and/or wires having a diameter between 1.5 mm and 5.0 mm.

Code	Description
5000002ST	Single clamp for small and medium FEP
5000003ST	Extended clamp for small and medium FEP
5000031ST	Single clamp for large FEP
5000032ST	Extended clamp for large FEP

## Arc-shaped connectors

Available in two layouts: 90° and 180°.

They allow screws and/or wires to be positioned on different planes in relation to the body of the fixator, ensuring greater stability of the implantation.

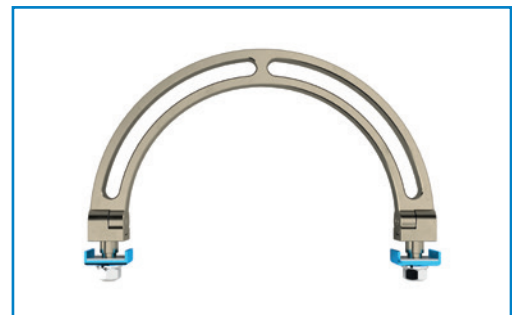
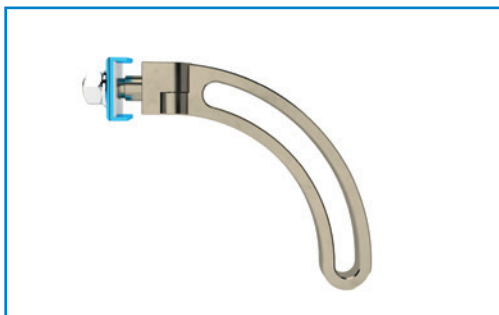

Code	Description
5000076	Adapter of mounting bracket for small and medium arc-shaped connector
5000080	90° Ø 120 mm connector for medium fixator
5000081	180° Ø 120 mm connector for medium fixator
5000082	180° Ø 160 mm connector for medium fixator
5000083	180° Ø 200 mm connector for medium fixator

# Spring-loaded cartridges for dynamization

Disposable, available in single and sterile packs.

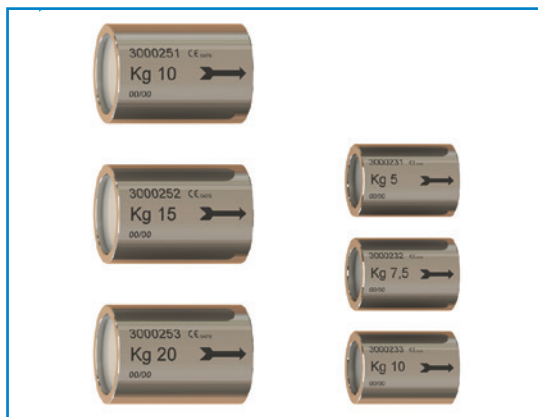

Code	Description
3000251ST	10kg large spring-loaded cartridge
3000252ST	15kg large spring-loaded cartridge
3000253ST	20kg large spring-loaded cartridge
3000231ST	5kg medium spring-loaded cartridge
3000232ST	7.5kg medium spring-loaded cartridge
3000233ST	10kg small spring-loaded cartridge

## Joint unit washer

Allows the joint unit of the body to perform a rotational movement only.

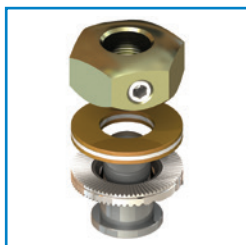

Code	Description
5000036	Smooth interface washer

## Sterilization

The FEP body, the arc-shaped connectors and the joint unit washer are shipped NON-sterile. The arc-shaped connector coded 500080 can also be shipped in a sterile package. The implantable devices and clamps are shipped sterile. It is recommended that NON-sterile instruments and devices be sterilized in a saturated steam autoclave as follows:

Code	Description	Q.ty
<b>5000180</b>	Complete FEP instrument sterilization set	
Composition:		
<b>5000127</b>	26-30 mm flat wrench	1
<b>5000123</b>	19-23 mm flat wrench	1
<b>5000121</b>	12 mm T-wrench	1
<b>5000122</b>	12 mm flat wrench	1
<b>5000600</b>	T-wrench for Ø 4.0 mm screws	1
<b>5000601</b>	T-wrench for Ø 5.0 mm screws	1
<b>5000602</b>	T-wrench for Ø 6.0 mm screws	1
<b>5000120</b>	Handle for Ø 4.0-5.0-6.0 mm screws	2
<b>5000124</b>	3.0 mm hexagonal screwdriver	1
<b>5000140</b>	12 mm L-shaped wrench	1
<b>5000144</b>	Cannula for Ø 4.0 mm screw guide	3
<b>5000145</b>	Cannula for Ø 5.0 mm screw guide	3
<b>5000146</b>	Cannula for Ø 6.0 mm screw guide	3
<b>5000147</b>	Cannula for Ø 7.0 mm screw guide	3
<b>5000141</b>	Cannula for Ø 2.5 mm drill guide	1
<b>5000142</b>	Cannula for Ø 3.5 mm drill guide	1
<b>5000143</b>	Cannula for Ø 4.5 mm drill guide	1
<b>5000148</b>	Screw insertion guide	1
<b>5000135</b>	Micrometric adjuster	2
<b>5000131</b>	Cannula for Ø 4.0 mm guide	1
<b>5000132</b>	Cannula for Ø 5.0 mm guide	1
<b>5000133</b>	Cannula for Ø 6.0 mm guide	1
<b>5000134</b>	Cannula for Ø 7.0 mm guide	1
<b>5000125</b>	Ø 4.0 mm hammering tip	1
<b>5000126</b>	Ø 6.0 mm hammering tip	1
<b>5000178</b>	Empty FEP instrument sterilization set	1

\* Implantable and sterile devices are covered by CE 1936 mark, non-sterile reusable instruments are CE marked





#### **HEADQUARTERS**

Via P. Gobetti, 56r - 16145 Genova  
Tel. +39 010 30801 - Fax +39 010 3080210  
[www.mikai.it](http://www.mikai.it) - [servizio.clienti@mikai.it](mailto:servizio.clienti@mikai.it)

#### **MANUFACTURING FACILITY**

Via Canestrello, 2 - 36050 Monteviale (VI)  
Tel. +39 0444 950100 - Fax +39 0444 950133  
[www.mikai.it](http://www.mikai.it) - [servizio.clienti@mikai.it](mailto:servizio.clienti@mikai.it)